

DIMENSION SKETCH AND MINIMUM DISTANCES

Scan 5007 with heat shield to fire wall (Accessory)

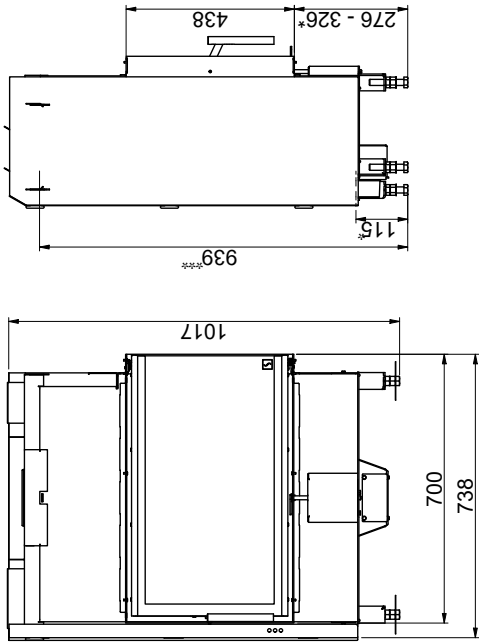

Scan 5007

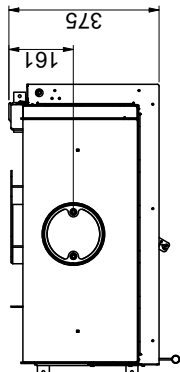
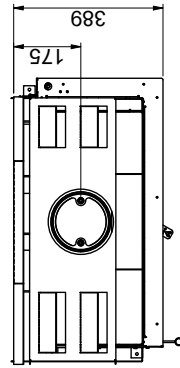
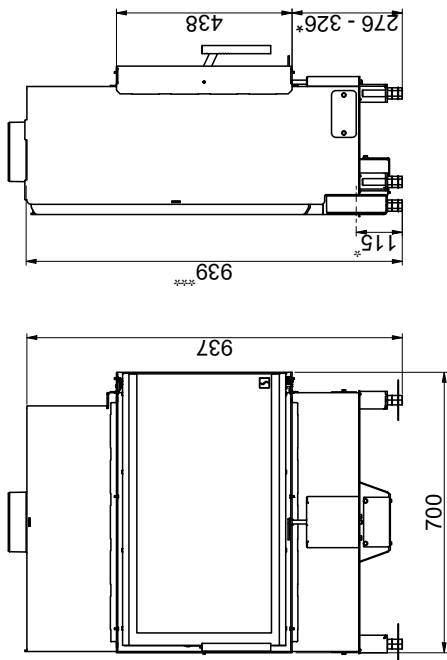

Floor plate

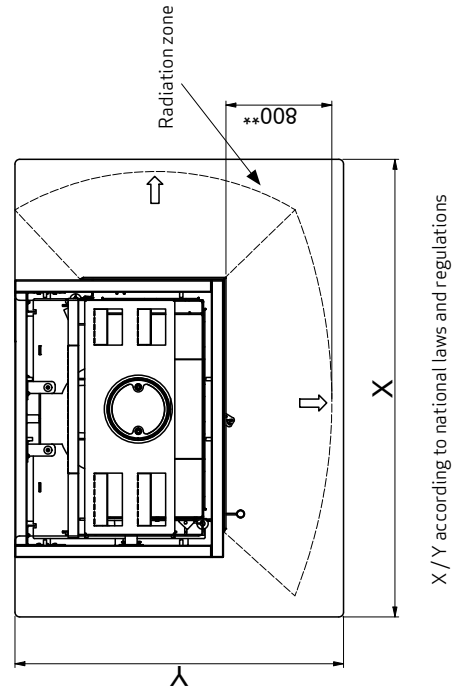

Flammable material

All distances are in mm.

All distances are minimum distances

\* Connection of fresh-air intake - inside measure: Ø132 mm - outside measure: 150 mm

\*\* Min. distance to furniture/flammable material

\*\*\* Height to the beginning of flue connecting piece at top/rear outlet,

flue conn. piece - inside measure: Ø132 mm - outside measure: Ø149 mm

X / Y according to national laws and regulations